



ES14-12TE

SPECIFICATIONS

Nominal Voltage (V) 12V

Nominal Capacity

20 hour rate (0.7A to 10.50V)	14Ah
10 hour rate (1.33A to 10.50V)	13.3Ah
5 hour rate (2.38A to 10.20V)	11.9Ah
1C (14A to 9.60V)	7.93Ah
3C (42A to 9.60V)	5.6Ah

Weight Approx. 9.68Lbs. (4.4kg)

Internal Resistance (at 1KHz) Approx. 10 mΩ

Maximum Discharge Current for 5 seconds : 210A

Operating Temperature Range

Charge	-15°C (5°F) to 40°C (104°F)
Discharge	-15°C (5°F) to 50°C (122°F)
Storage	-15°C (5°F) to 40°C (104°F)

Charge Retention (shelf life) at 20°C (68°F)

1 month	92%
3 months	90%
6 months	80%

Charging Methods at 25°C (77°F)

Cycle Use : Charging Voltage 14.4 to 15.0V
Coefficient -5.0mv / °C / cell
Maximum Charging Current : 4.2A

Standby Use : Float Charging Voltage 13.50 to 13.80V
Coefficient -3.0mv / °C / cell

Case Material : ABS
(Option : UL94 HB Flame Retardant Case Material)

Terminal : F6

Terminal Hardware Torque Value :

Recommended	M5: 2.94 Nm (30kg-cm)
Maximum Allowable	M5: 4.90 Nm (50kg-cm)

Maintenance-Free Rechargeable Sealed Lead-Acid Battery



DIMENSIONS

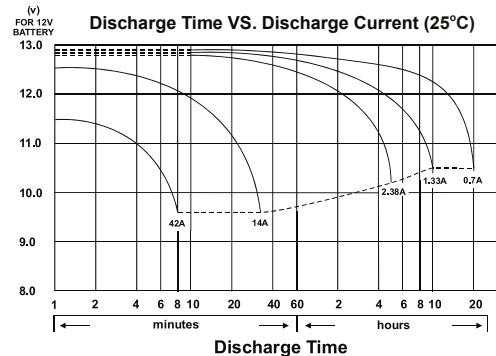
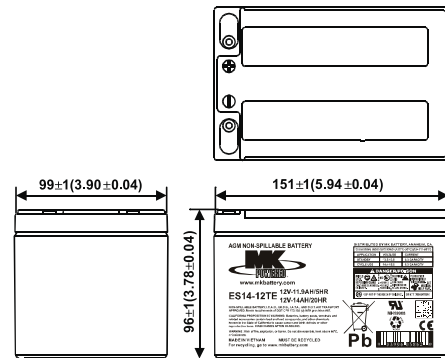
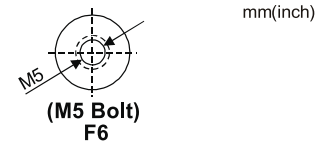

MK Battery

1631 South Sinclair Street • Anaheim, California 92806

Toll Free: 800-372-9253 • Fax: 714-937-0818 • E-mail: sales@mkbattery.com

