

MOTOBATT

QuadFlex™ Battery
 WWW.MOTOBATT.COM
 MBT14B4



Features

- Patented Quad Terminal Design - Reduce carrying costs
- 12V VRLA Hi Capacity Starting Battery
- Absorbed Glass Mat (AGM) technology
- Brass Terminals - superior conductivity
- US DOT, IATA certified non-spillable
- Highest AH Capacity in the Industry
- Factory Activated-Ready to Install

Performance Specifications

Nominal Voltage ----- 12 volts (6 cells)

Nominal Capacity

20-hr. (0.65A to 10.50 volts)-----	13.4 AH
10-hr. (1.3A to 10.50 volts)-----	13.0 AH
5-hr. (2.6A to 10.20 volts)-----	11.1 AH
1C. (13A to 9.6 volts)-----	41Min (8.9AH)
8C. (104A to 6.00 volts)-----	3 Min (5.2AH)

Approximate Weight ----- 9.04 lbs. (4.1kg)

Energy Density (20-hr. rate) ----- 1.74W-h/in³ (105.6 W-h/l)

Specific Energy (20-hr. rate) ----- 17.79W-h/lb (39.2 W-h/kg)

Internal Resistance (approx) ----- 26 milliohms

CCA (-0.4°F/-18°C,7.2V,30S)----- 175 amperes

CA (68°F/20°C,7.2V,30S)----- 240 amperes

Shelf Life (% of nominal capacity at 68°F (20°C)---- SOC% OCV

1 Months -----	97%	12.78V
3 Months -----	91%	12.7V
6 Months -----	83%	12.5V

Operating Temperature Range

Charge -----	-4°F (-20°C) to 122°F (50°C)
Discharge -----	-40°F (-40°C) to 140°F (60°C)

Case ----- ABS

Carton Contents ----- 1-MotoBatt MBT14B4 Battery,
 4 stainless steel terminal screws, 2 pairs of brass terminals, 4mm
 Allen Wrench, Install / user manual.



"C" TERMINAL TERMINAL COVER SCREW WRENCH

RETAIL CARTON

Brass Terminals (mm)

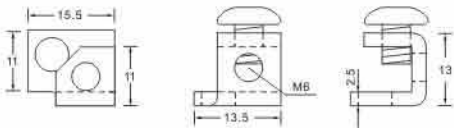

Terminal Screws: Stainless, M6 Thread
 Fastener: 4mm Allen Hex

Physical Dimensions: (in./mm)

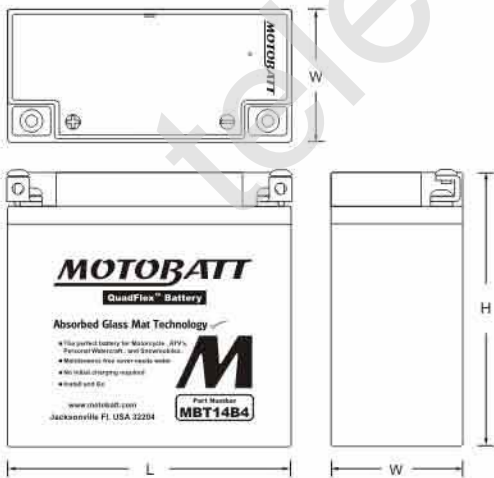

L: 5.90(150) W: 2.75(70) H: 5.71(145)

Tolerances are +/0.04in.(+/1mm) and +/0.08in.(+/2mm) for height dimensions.

Shelf life & Storage

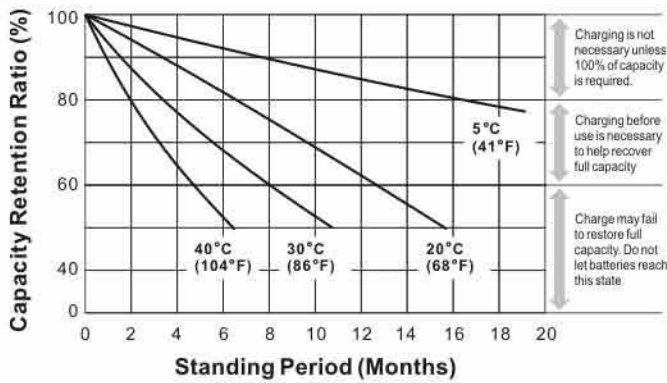

Discharge Characteristics

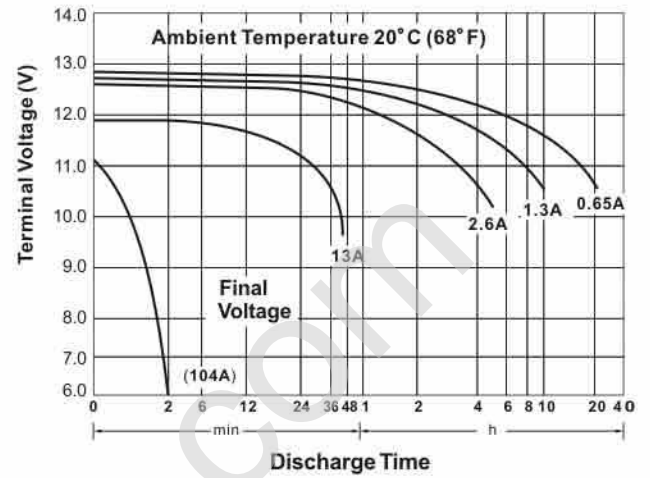

Discharge Time vs. Discharge Current

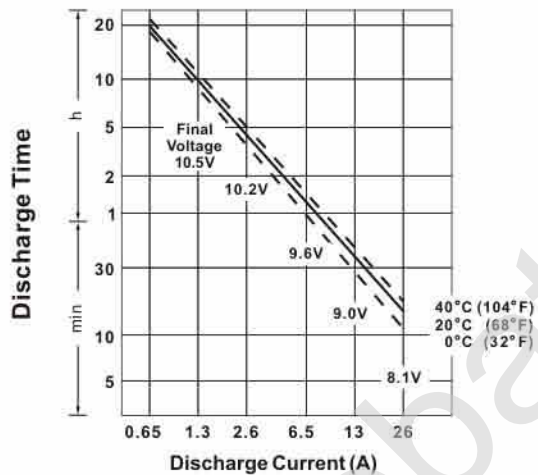

Life Characteristics in Cyclic Use

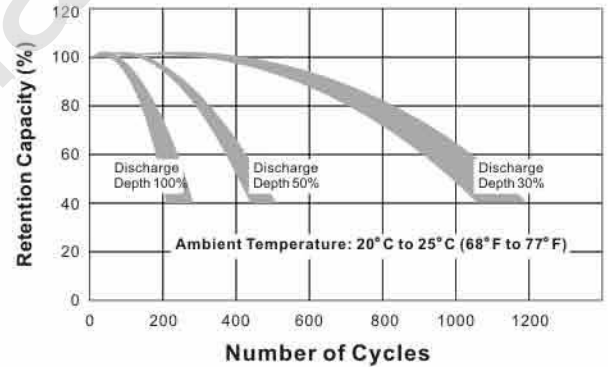

Charging

Cycle Applications: limit initial current to 3.9A. Charge until battery voltage (under charge) reaches 14.8 to 15.0 volts at 68°F(20°C). Hold at 14.8 to 15.0 volts until current drops to under 250mA. Battery is fully charged under these conditions, and charger should be disconnected or switched to "float" voltage.

Note: Due to the self-discharge characteristics of this type of battery, it is imperative that they be charged within 6 months of storage, otherwise permanent loss of capacity might occur as a result of sulfation.

Can be used to replace

YT14BBS	YT14B4		

Chargers

MotoBatt offers a wide range of chargers suitable for batteries up to 4A. Please refer to the charger selection guide. Please contact our technical department for advice if you have difficulty in locating suitable models or contact us at www.motobatt.com

Further Information

Please refer to our website www.motobatt.com to locate a distributor in your area.