

MOTOBATT

QuadFlex™ Battery
 WWW.MOTOBATT.COM
 MBTX4U



Features

- Patented Quad Terminal Design - Reduce carrying costs
- 12V VRLA Hi Capacity Starting Battery
- Absorbed Glass Mat (AGM) technology
- Brass Terminals - superior conductivity
- US DOT, IATA certified non-spillable
- Highest AH Capacity in the Industry
- Factory Activated-Ready to Install

Performance Specifications

Nominal Voltage ----- 12 volts (6 cells)

Nominal Capacity

20-hr. (0.235A to 10.50 volts)-----	4.8AH
10-hr. (0.47A to 10.50 volts)-----	4.7 AH
5-hr. (0.94A to 10.20 volts)-----	4.0 AH
1C. (4.7A to 9.6 volts)-----	46Min (3.6AH)
8C. (37.6A to 6.00 volts)-----	3Min (1.88AH)

Approximate Weight ----- 3.46 lbs. (1.57kg)

Energy Density (20-hr. rate) ----- 1.36W-h/in³ (83.0 W-h/l)

Specific Energy (20-hr. rate) -----16.6W-h/lb (36.7 W-h/kg)

Internal Resistance (approx) ----- 22 milliohms

CCA (-0.4°F/-18°C,7.2V,30S)----- 70 amperes

CA (68°F/20°C,7.2V,30S)----- 120 amperes

Shelf Life (% of nominal capacity at 68°F (20°C)---- SOC% OCV

1 Months -----	97%	12.78V
3 Months -----	91%	12.7V
6 Months -----	83%	12.5V

Operating Temperature Range

Charge -----	-4°F (-20°C) to 122°F (50°C)
Discharge -----	-40°F (-40°C) to 140°F (60°C)

Case ----- ABS

Carton Contents -----1-MotoBatt MBTX4U Battery,
 4 stainless steel terminal screws, 2 pairs of brass terminals, 3mm
 Allen Wrench, Install / user manual.



RETAIL CARTON



"C" TERMINAL TERMINAL COVER SCREW WRENCH

Brass Terminals (mm)

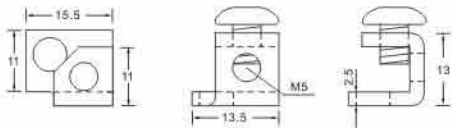

Terminal Screws: Stainless, M5 Thread
 Fastener: 3mm Allen Hex

Physical Dimensions: (in./mm)

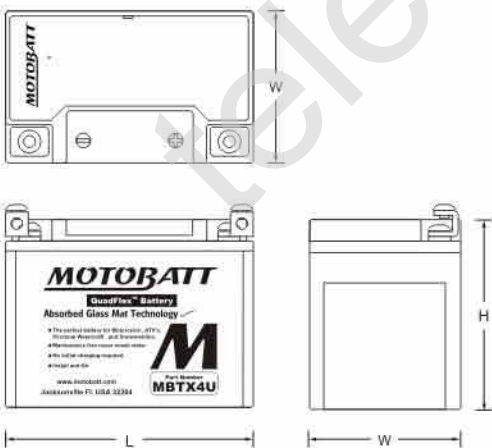

L:4.49(114) W:2.75(70) H:3.42(87)

Tolerances are +/0.04in.(+/-1mm) and +/0.08in.(+/-2mm) for height dimensions.

Shelf life & Storage

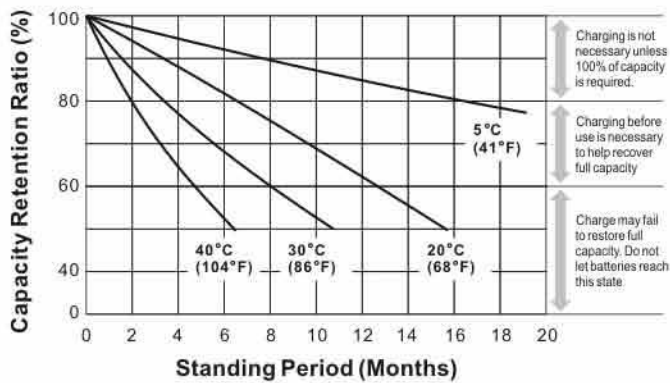

Discharge Characteristics

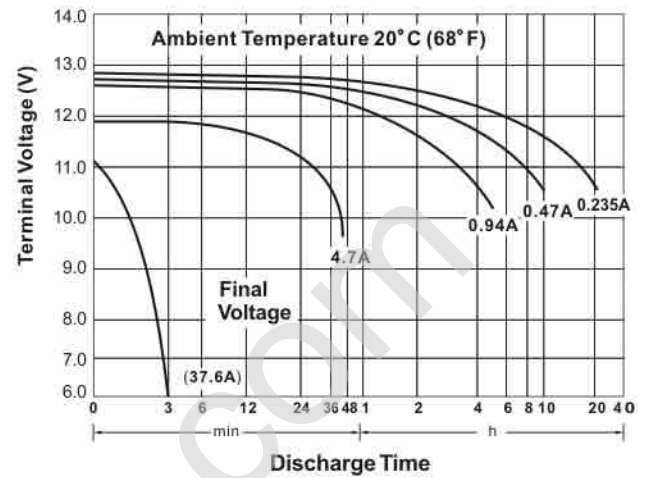

Discharge Time vs. Discharge Current

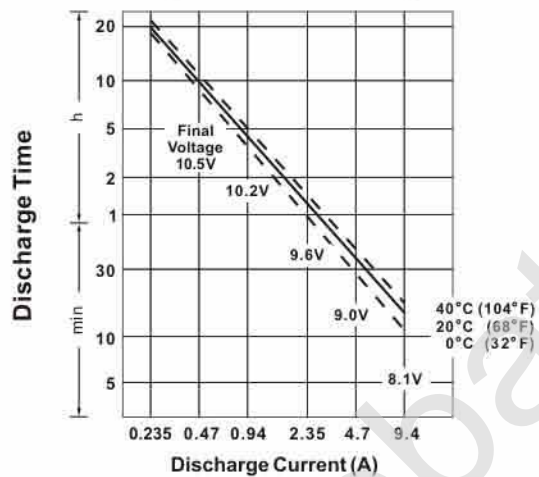

Life Characteristics in Cyclic Use

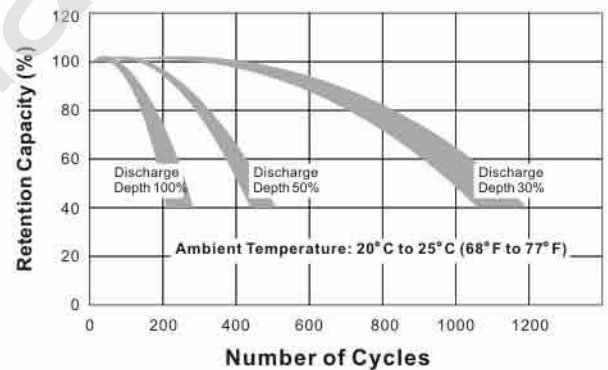

Charging

Cycle Applications: limit initial current to 1.41A. Charge until battery voltage (under charge) reaches 14.8 to 15.0 volts at 68°F(20°C). Hold at 14.8 to 15.0 volts until current drops to under 100mA. Battery is fully charged under these conditions, and charger should be disconnected or switched to "float" voltage.

Note: Due to the self-discharge characteristics of this type of battery, it is imperative that they be charged within 6 months of storage, otherwise permanent loss of capacity might occur as a result of sulfation.

Can be used to replace

YT4LBS	YT4LBS	YB4LA	YB4LB
YTZ5S			

Chargers

MotoBatt offers a wide range of chargers suitable for batteries up to 2A. Please refer to the charger selection guide. Please contact our technical department for advice if you have difficulty in locating suitable models or contact us at www.motobatt.com

Further Information

Please refer to our website www.motobatt.com to locate a distributor in your area.